



TRUE BLUE® BATH WASTE HALF KIT

Job Name _____	Item # _____
Location _____	
Engineer _____	Contractor _____
PO # _____	Tag _____
Representative _____	

SPECIFICATIONS

The Dearborn True Blue Bath Waste shall be used in commercial and residential applications requiring a bath waste and overflow drain with integrated test features. Overflow and drain elbow components shall come factory preassembled for added convenience. Overflow gasket shall be made of a high memory foamed rubber. Drain gasket shall be notched and undercut in order to wrap around drain elbow and lock into place. This will prevent gasket from being knocked off during installation and remain secured to drain elbow regardless of orientation. Test plugs shall be quarter turn installation and must be removable and reusable. Overflow test plug shall be used to install the designer trim veneer with a quarter turn and will not require additional tools or sealants for installation. Faceplate installation shall not require additional tools or screws, symmetrical design will eliminate the need for precise alignment.

APPROVALS AND LISTINGS

ASME A112.18.2-2015/CSA B125.2-15



Uniform Plumbing Code (UPC®)



National Plumbing Code of Canada



International Plumbing Code (IPC®)



ASME A112.18.2-2015/CSA B125.2-15

Listed with Massachusetts Board of Plumbing

FEATURES AND MATERIALS

Finish Trim	Tool-Free, Screw-Free Installation
Test Plugs	Reusable, Quarter Turn Tool-Free Installation
Drain Gasket	Locking Rubber Gasket
Overflow Gasket	High Memory Foamed Rubber
Spud	Chrome Plated Brass

PERFORMANCE SPECIFICATIONS

Test Plug Rating	40 FT Head, 17 PSI
Flow Rate	10.95 GPM

DIMENSIONS

[A]:	Drain / Spud Thread	1-1/2" – 11.5 NPSM
[B]:	Inner Diameter	1-1/2" SCH 40 Pipe
[C]:	Inner Diameter	1-1/2" SCH 40 Pipe
[D]:	Overflow Depth	1.236"

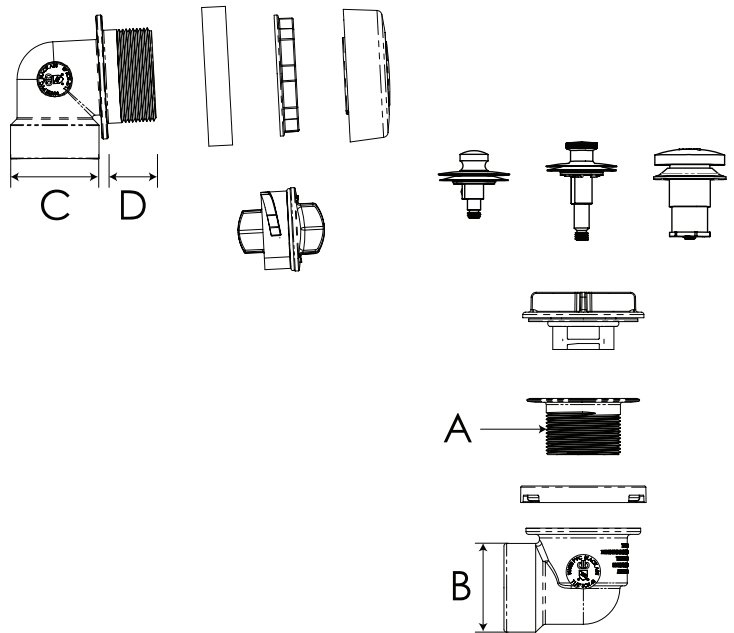

Access BIM/Revit content through www.oatey.com



TRUE BLUE® BATH WASTE HALF KIT

PRODUCT SELECTOR

TRUE BLUE® BATH WASTE HALF KIT						
✓	Product Number	Material	Stopper Style	Finish	Drain Spud Material	Test Plug Included
	A9940	ABS	Push & Pull	Chrome	Chrome Plated Brass	No
	A9940CP	ABS	Push & Pull	Chrome	Chrome Plated Brass	Yes
	A9940BN	ABS	Push & Pull	Brushed Nickel	Chrome Plated Brass	Yes
	A9940RB	ABS	Push & Pull	Oil Rubbed Bronze	Chrome Plated Brass	Yes
	A9940BGPS	ABS	Push & Pull	Brushed Gold*	Chrome Plated Brass	Yes
	A9940WH	ABS	Push & Pull	White	Chrome Plated Brass	Yes
	A9940MB	ABS	Push & Pull	Matte Black	Chrome Plated Brass	Yes
	A9950	ABS	Touch Toe	Chrome	Chrome Plated Brass	No
	A9950CP	ABS	Touch Toe	Chrome	Chrome Plated Brass	Yes
	A9950BN	ABS	Touch Toe	Brushed Nickel	Chrome Plated Brass	Yes
	A9950RB	ABS	Touch Toe	Oil Rubbed Bronze	Chrome Plated Brass	Yes
	A9950BGPS	ABS	Touch Toe	Brushed Gold*	Chrome Plated Brass	Yes
	A9950WH	ABS	Touch Toe	White	Chrome Plated Brass	Yes
	A9950MB	ABS	Touch Toe	Matte Black	Chrome Plated Brass	Yes
	A9960	ABS	Uni-Lift	Chrome	Chrome Plated Brass	No
	A9960CP	ABS	Uni-Lift	Chrome	Chrome Plated Brass	Yes
	A9960CPZ	ABS	Uni-Lift	Chrome	Chrome Plated Zinc	Yes
	A9960BN	ABS	Uni-Lift	Brushed Nickel	Chrome Plated Brass	Yes
	A9960RB	ABS	Uni-Lift	Oil Rubbed Bronze	Chrome Plated Brass	Yes
	A9960BGPS	ABS	Uni-Lift	Brushed Gold*	Chrome Plated Brass	Yes
	A9960WH	ABS	Uni-Lift	White	Chrome Plated Brass	Yes
	A9960MB	ABS	Uni-Lift	Matte Black	Chrome Plated Brass	Yes
	P9950	PVC	Touch Toe	Chrome	Chrome Plated Brass	No
	P9950CP	PVC	Touch Toe	Chrome	Chrome Plated Brass	Yes
	P9950BN	PVC	Touch Toe	Brushed Nickel	Chrome Plated Brass	Yes
	P9950RB	PVC	Touch Toe	Oil Rubbed Bronze	Chrome Plated Brass	Yes
	P9950BGPS	PVC	Touch Toe	Brushed Gold*	Chrome Plated Brass	Yes
	P9950WH	PVC	Touch Toe	White	Chrome Plated Brass	Yes
	P9950MB	PVC	Touch Toe	Matte Black	Chrome Plated Brass	Yes
	P9960	PVC	Uni-Lift	Chrome	Chrome Plated Brass	No
	P9960CP	PVC	Uni-Lift	Chrome	Chrome Plated Brass	Yes
	P9960CPZ	PVC	Uni-Lift	Chrome	Chrome Plated Zinc	Yes
	P9960BN	PVC	Uni-Lift	Brushed Nickel	Chrome Plated Brass	Yes
	P9960RB	PVC	Uni-Lift	Oil Rubbed Bronze	Chrome Plated Brass	Yes
	P9960BGPS	PVC	Uni-Lift	Brushed Gold*	Chrome Plated Brass	Yes
	P9960WH	PVC	Uni-Lift	White	Chrome Plated Brass	Yes
	P9960MB	PVC	Uni-Lift	Matte Black	Chrome Plated Brass	Yes

*PVD Finish

Access BIM/Revit content through www.oatey.com



TRUE BLUE® BATH WASTE HALF KIT

PRODUCT SELECTOR

TRUE BLUE® BATH WASTE HALF KIT						
✓	Product Number	Material	Stopper Style	Finish	Drain Spud Material	Test Plug Included
	P9940	PVC	Push & Pull	Chrome	Chrome Plated Brass	No
	P9940CP	PVC	Push & Pull	Chrome	Chrome Plated Brass	Yes
	P9940BN	PVC	Push & Pull	Brushed Nickel	Chrome Plated Brass	Yes
	P9940RB	PVC	Push & Pull	Oil Rubbed Bronze	Chrome Plated Brass	Yes
	P9940BGPS	PVC	Push & Pull	Brushed Gold*	Chrome Plated Brass	Yes
	P9940WH	PVC	Push & Pull	White	Chrome Plated Brass	Yes
	P9940MB	PVC	Push & Pull	Matte Black	Chrome Plated Brass	Yes

TRUE BLUE® BATH WASTE TRIM KIT							
✓	Product Number	Stopper Style	Finish	✓	Product Number	Stopper Style	Finish
	K97WH	Touch Toe	White		K98RB	Uni-Lift	Oil Rubbed Bronze
	K97MB	Touch Toe	Matte Black		K98BG	Uni-Lift	Brushed Gold*
	K97CP	Touch Toe	Chrome		K98BGPS	Uni-Lift	Brushed Gold*
	K97BN	Touch Toe	Brushed Nickel		K99WH	Push & Pull	White
	K97RB	Touch Toe	Oil Rubbed Bronze		K99MB	Push & Pull	Matte Black
	K97BG	Touch Toe	Brushed Gold*		K99CP	Push & Pull	Chrome
	K97BGPS	Touch Toe	Brushed Gold*		K99BN	Push & Pull	Brushed Nickel
	K98WH	Uni-Lift	White		K99RB	Push & Pull	Oil Rubbed Bronze
	K98MB	Uni-Lift	Matte Black		K99BG	Push & Pull	Brushed Gold*
	K98CP	Uni-Lift	Chrome		K99BGPS	Push & Pull	Brushed Gold*
	K98BN	Uni-Lift	Brushed Nickel				

*PVD Finish

Access BIM/Revit content through www.oatey.com